

PORTABLE SUN HAIL PROTECTOR



Email: sunhail@bigpond.com

Web: www.sunhail.com

CONTENTS

A NOTE TO THE OWNER	Pg 2
FOREWORD	Pg 3
SAFETY	Pg 4
PARTS LIST	Pg 5
PARTS LIST cont.	Pg 6
PART IDENTIFICATION	Pg 7
ASSEMBLY INSTRUCTIONS	Pg 8
ASSEMBLY INSTRUCTIONS	Pg 9
SPECIFICATION DRAWING	Pg 10
PRODUCT WARRANTY	Pg 11
PHOTOS	Pg 12

SUN HAIL PROTECTOR

A NOTE TO THE OWNER

List of Benefits.

The **Sun-Hail Protector** is a well constructed Australian Made Design and product which will last the life time of your Vehicle as parts are available to replace those you may need to keep your **Sun-Hail Protector** in good condition for resale to another party or an added attraction to a purchaser of your vehicle.

The **Sun-Hail Protector** is an efficient way of either reducing or avoiding:

- a) UV damage to your Vehicles paint
- b) Inside trim particularly your Dashboard
- c) Inside Vehicle temperature
- d) Damage from other vehicle opening doors
- e) Hail Damage
- f) Made from at least 50mm Steel and Stainless Steel wire and clips.

The **Sun Hail Protector** will fit within most countries longer term parking allocations such as day parking in open parking environments, however check with your local authority.

Longer Term parking such as your rented home or that extra Sun Cover home parking space, is by bolting the **Sun-Hail Protector** to a concrete area. **Please Note:** a larger Canopy is available to ensure extra walking around space and unfettered access to your vehicle. See Parts List SH-040.

Finally, the **Sun-Hail Protector** can be assembled or dissembled and back into your Trunk/Boot within 5 minutes of each application. Please note the maximum length of the longest pole is 1350mm which will fit over 90 % of vehicles Trunk/Boot , just to be sure (and depending on your application i.e. Daily parking or Semi Permanent home or office parking) check your size requirements before purchasing.

- 2 -

SUN HAIL PROTECTOR

FOREWORD

Patent / Design #	10361/2008
Trade Mark Design #	319004 / AU 319004 S
Engineering Drawings:	DK DRAFTING PTY/LTD
Marketed World Wide by:	Balair International Pty Ltd (Australia)

*We would like to congratulate you on selecting one of our **Sun Hail Protectors** above all the other various products on the market today.*

***Sun Hail Protectors** are all Australian made/Designed and we know that you will enjoy many years of protective service.*

*This manual guides you through a number of important points needed to be able to Assemble & use our **Sun hail Protector** safely, effectively & efficiently. We advise you to read this manual thoroughly before commencement of use.*

We have strived for excellence in design and service, to provide the best possible product that you as a customer deserve.

Please Note: Front and rear are as seen from your driving position.

SUN HAIL PROTECTOR

- 3 -

SAFETY

- ⚙️ Engineering data recommends usage to (60kms) 35 mile per hour wind speed.
- ⚙️ Read this manual thoroughly before using your Sun Hail Protector.
- ⚙️ Do not attempt to put up the Sun Hail Protector until the vehicle is driven onto the base plates. Disassemble the same way.
- ⚙️ Ensure an inspection of parts has been completed prior to assembly.
- ⚙️ **CAUTION:** Never attempt to move the vehicle whilst base plates are being positioned.
- ⚙️ When assembling Sun Hail Protector, always ensure parts are fitted correctly.
- ⚙️ Never place hands near any pinch points. Use gloves as supplied. 
- ⚙️ Always ensure there is ample overhead clearance before assembling the Sun Hail Protector.
- ⚙️ Read and obey all decals placed on the Sun Hail Protector

4



PARTS LIST

ITEM No	QTY	PART No	DESCRIPTION
1	1	SH-001	Right Rear Base Plate
2	1	SH-002	Left Rear Base Plate
3	1	SH-003	Left Front Base Plate
4	1	SH-004	Right Front Base plate
5	2	SH-008	Short Extension
6	2	SH-009	Medium Extension
7	2	SH-016	Locking Post
8	1	SH-013	Top Leg (No Hook)
9	3	SH-035	Top Leg (With Hook)
10	3	SH-005	Bottom Leg
11	1	SH-032	Bottom Tensioner Leg
12	1	SH-042	Ratchet Tensioning device
13	1	SH-038	Tensioning Wire (Short)
14	1	SH-037	Tensioning Wire (Long)
15	1	SH-043	SUV long top Extension



5

PARTS LIST

ITEM No	QTY	PART No	DESCRIPTION
16	4	SH-050	Clip
17	1	SH-026	2.5mtrs x 5.8mtrs Canopy (Medium to Large Sun Hail Protector)
18	1	SH-027	5.3mtrs x 2.3mtrs Canopy (Small to Medium Sun Hail Protector)
19	1	SH-040	3.1mtrs x 6.4mtrs Canopy (Semi Permanent Bolt to ground)
20	3	SH-600	Anti Theft Locking Kit (Includes parts listed below)
21	3	SH-110	Anti Theft Lock
22	11	SH-112	Padlock
23	11	SH-111	Lock Pin

For a snug fit: Measurements of canopy should be nearest to your vehicles "Bumper to Bumper" (length/width) then order from the above Item No 17,18,19.
 Colours of Canopy available: Royal Blue, Rain forest Green, Terracotta, Black, Charcoal.
 To view colour samples go to: www.sunhailprotector.com - Click the colour tab.

PART IDENTIFICATION

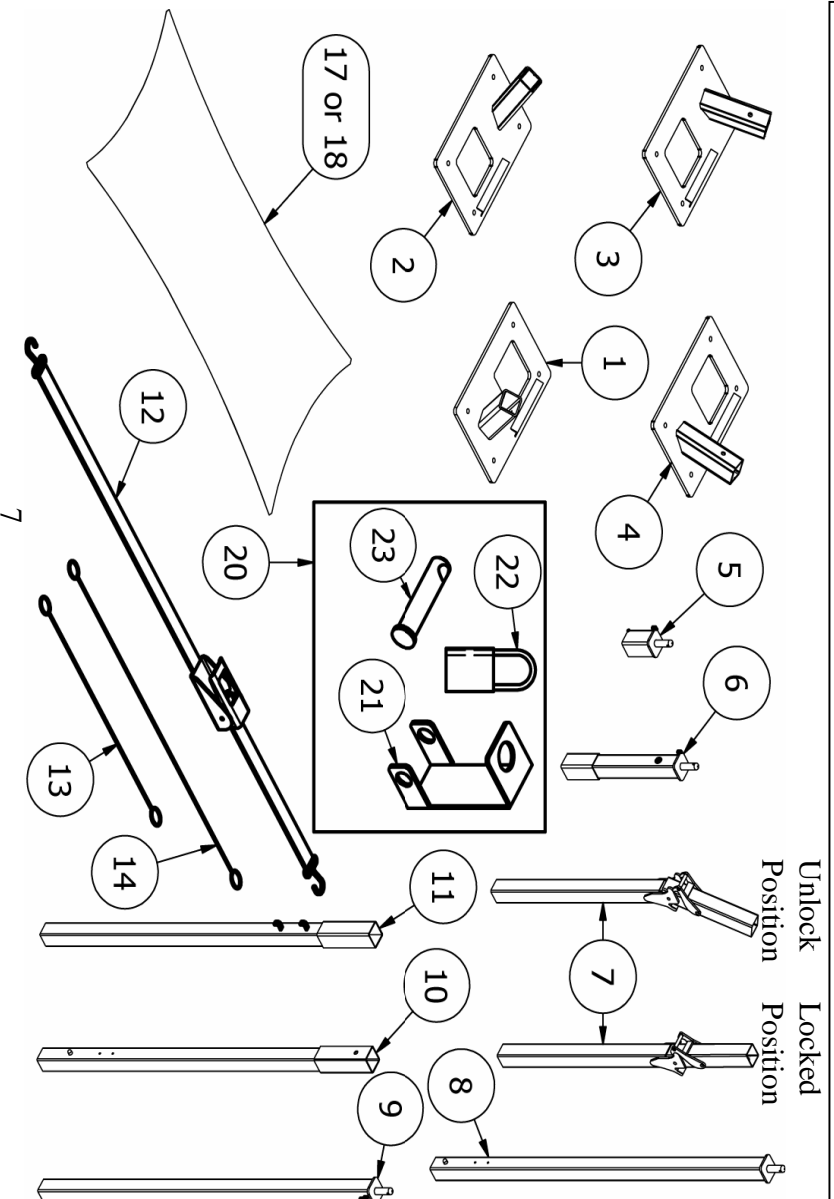

ASSEMBLY INSTRUCTIONS

- 1: Select bags numbered 1 to 4 and place each bag at the designated vehicle wheel "Example RR means Right Rear; LF is Left front etc" then footing covers "A" to "D" as above.
- 2: Remove items "A" to "D" (SH-001 to SH-004 inclusive) from each bag placing each base plate at the front of the tyre. See Parts ID 1-4.

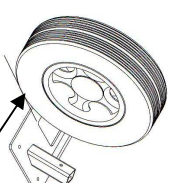

NOTE: The tyre roll stops are always at the front of the BASE Plates (See items 1 thru 4 of Parts Identification Pg 7) further, make sure that all base plates fit under the tyre with a straight line to the" Road Grip Hole" in the foot plate lined with the edge of the tyre.

- 3: Drive vehicle up onto the base plates with the tyres centered "Approximately" in the Grip Square cut out of the Base Plate.
- 4: Select bottom leg from each bag (SH-005 or Part ID 8,9,10,11) keeping the Welded Square Insert sleeve to the top, then push the Legs into the Base Plates SH-002, SH-003, SH-004 ensuring they lock-in. Ensure that SH-032 is fitted to SH-001 Base Plate as this is the main Tensioning leg.
- 5: Select Locking post (SH-016 or Part ID 7) and insert into the sleeve in the already fitted bottom leg assembly and break the Latch always towards the vehicle. **NOTE:** Locking Post must always be fitted to one front and one rear assembly. (Which front & rear depends on which setup you need)
- 6: Select the Medium (SH-009) or Short assembly (SH-008) depending on the height of your vehicle and snap into place on one front and one rear Locking Post.
- 7: **NOTE:** insure all snap pins are in place securely and visible within the pin holes.

Cont on Page 9

ASSEMBLY INSTRUCTIONS

Take bag number 5 (Part ID 17,18) and remove the Screen Netting (SH-026 or SH-027 – Depending on which vehicle kit you purchased)

- 8: Roll out the Canopy and fold in half (length ways), slide it between the vehicle and the leg assemblies on the drivers side of the vehicle front to back. Check front label on the underside of the canopy.
- 9: Check to make sure that both Locking Posts are in the unlock Position, (they should be leaning towards the Vehicle – See Pg 7 Part ID 7) then take the corner of the net and place the first hole in the Screen Net over the extension (SH-008 or SH-009 – Depending on setup) and insert the locking pin (SH-050) into the hole. Ensure the corner that has the Tensioner wire Mechanism is to the right rear of the vehicle. **NOTE: Do not affix the position lock pin at this time.**
- 10: After completion of hanging all four corners of the canopy, affix all locking pins (SH-050) into place, pull on the top of the Locking Post one at a time until they lock (See Pg 7 SH-016).
- 11: Pull wire under the Wire Hook provided on the poles for the Right front (RF), Left rear (LR) and Left front (LF). The remaining group of wire are on the front left hand pole.
- 12: Adjustments to fit the vehicle under the canopy is by the combination of the corner adjustment slots being selected as required to either reduce or increase the size of your UNDER CANOPY area, along with a one point wire tightening position on the Right Rear Pole Positioning. The tightening is completed by a Ratchet hand tightening device supplied as Part Number SH-042.
- 13: Adjust wire tension so the Canopy is tight. **Please note:** To tighten the canopy itself will not be achieved by the wire adjustment alone, rather break the latches on SH-016 on the (RF) and (LR) and always PUSH POLE to the appropriate canopy ring as this is where the canopy is adjusted to fit the vehicle, then lock the legs. Once you are happy the canopy is taut, re address the wire tension.



SPECIFICATION DRAWING

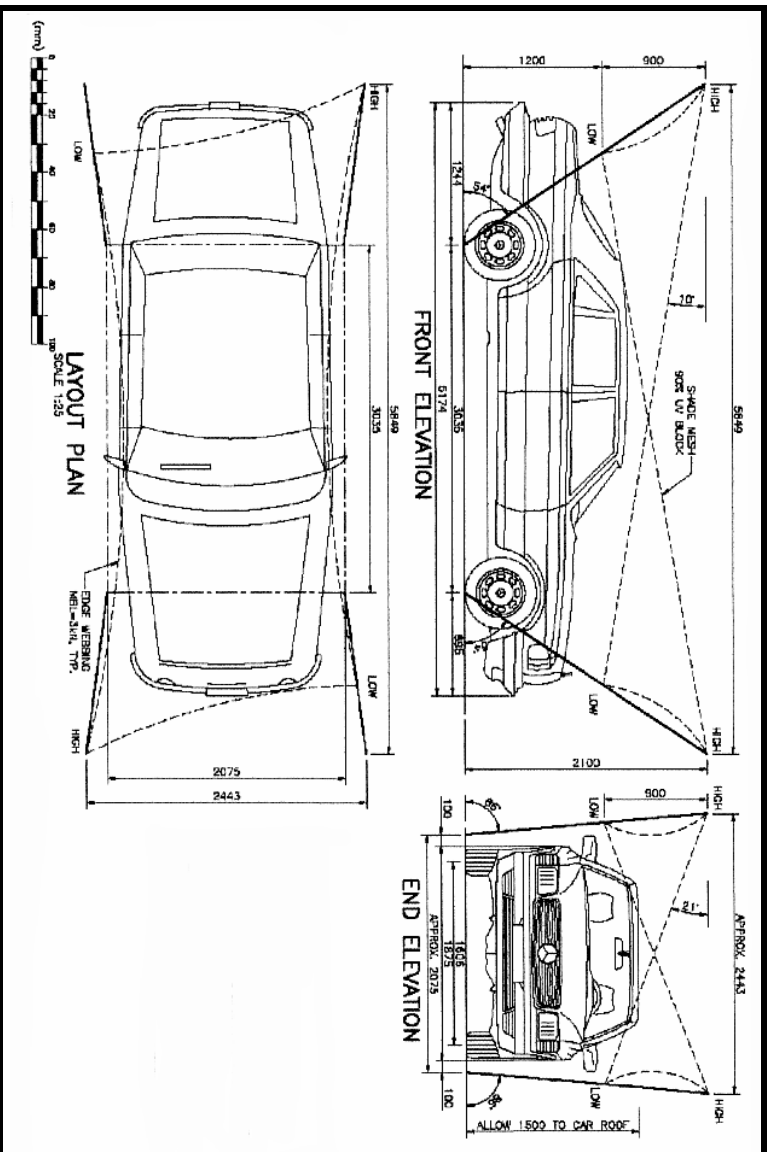

10

SUN HAIL PROTECTOR

PRODUCT WARRANTY

Effective Date: June 1, 2009

All products are sold subject to the following terms and conditions set forth herein.

All new **Sun Hail Protector** products are warranted to be free from defects in material and workmanship which may cause failure under normal usage and service when used for the purpose intended.

Sun Hail Protector warrants its equipment or parts against defects in design, material and workmanship for a period of twelve (12) months from date of shipment. The warranty does not extend to transportation cost of parts. All warranty claims need to be made within fourteen (14) days of finding fault. If not the warranty is deemed null and void.

The Sun Hail Protector must be used in accordance with the recommended procedures and within the ranges as specified and contained in the operating manual.

The warranty contained herein shall terminate if the equipment failure giving rise to a claim under warranty results from (a) unauthorized modification, repair or alteration, (b) improper operation, application, maintenance or installation, (c) damage during shipment, (d) operation, handling or other dealings with the equipment in a negligent way.

Except to the extent specifically set forth in this limited warranty, Sun Hail Protector shall not be liable and disclaims all liability for consequential damage or injury (fatal or otherwise) of every kind (whether classified as direct, special, indirect, incidental or consequential damages).

The Warranty claim will not be recognized without return of faulty parts.

SUN HAIL PROTECTOR

